

CONTENT:

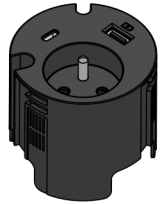

x1



x1



x1

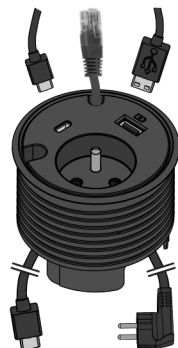

- 1 USB Charger QC2.0 (Type-A)
- 1 French socket /w 1250 mm cable
- 1 USB Port (Type-C Female) /w 1000 mm cable
- 2 feed-throughs (Ø7, Ø9.5 mm)

1 DRILL

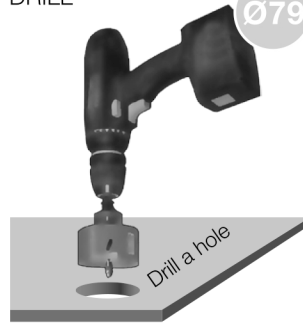

2 INSERT

Insert grommet into the hole, then feed the plug all the through the threaded fastening nut.

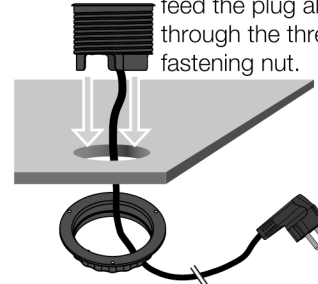

3

TURN CLOCKWISE & PLUG IN

Turn the fastening nut as far up the thread as possible. Make sure that it has been thoroughly tightened. Plug the French plug into a wall socket or powerstrip of your choice. Lastly, connect the the USB-C cable to intended device.

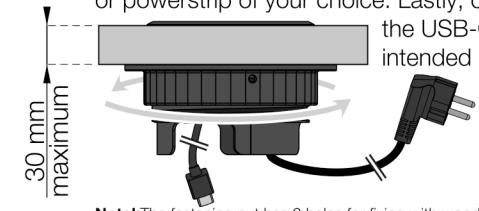

Note! The fastening nut has 3 holes for fixing with wood screws.

A

ADJUSTING HEIGHT

Connect plug to Powerdot to begin releasing the inner part of the grommet.

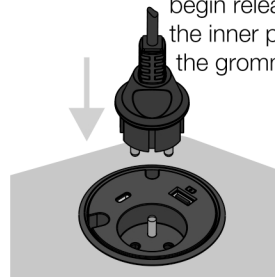

B

RELEASE INNER PART

Rotate plug counter-clockwise to release the inner part.

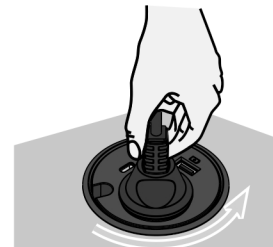

C

ADJUSTING HEIGHT

The inner part should now be loose. Adjust to desired level - see box: ADJUST LEVELS

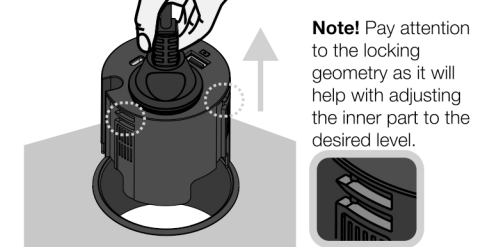

Note! Pay attention to the locking geometry as it will help with adjusting the inner part to the desired level.

!

ADJUST LEVELS

Level 2 must be used when combined with the decorative accessories.

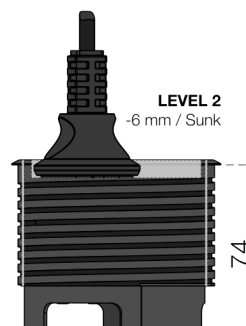
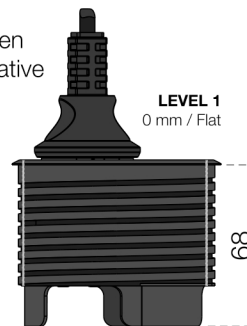
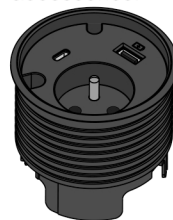

D

LOCKING POSITION

Rotate clockwise.

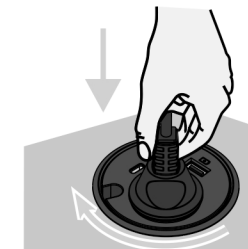

E

LOCKING POSITION

Rotate clockwise.

